

Department of Civil & Environmental Engineering

3+1+1 Program with Partner University

Contacts



Associate Professor Poh Leong Hien (傅勇宪)

Associate Head (Academic)

Department of Civil and Environmental Engineering

Email: leonghien@nus.edu.sg



Ms Sally Ng Xin Hui (黄馨慧)

Executive

Department of Civil and Environmental Engineering

Email: sally.ng@nus.edu.sg

Contents

- Introduction to NUS CEE Department NUS CEE 学院简介
- Overview of 311 program 311 项目总览
- Program requirements 项目要求
- Fees and expenses 项目花费
- Timeline 项目时间线
- NUS MSc(CE) Program NUS 授课型硕士项目介绍



3+1+1 Joint Educational Programme

Overview of NUS Civil & Environmental Engineering (CEE)

- **Number of faculty members** 学院教师情况总览
 - 16 full professors, 13 associate professors, 8 assistant professors, 6 lecturers/senior lecturers and 4 practice-track professors/associate professors.

	QS Ranking	Times Higher Education Ranking
Subject	Civil and Structural Engineering	Engineering and Technology
2023	4	8
2022	3	10
2021	2	12





3+1+1 Program

Overseas experience in a familiar environment 在熟悉文化环境下的海外体验

- Exposure to a different study environment 体验不同的学习环境
- Work with quality professors in a top university 与顶尖院校的教授共同工作学习
- Network with future international colleagues 拓宽国际化的人脉
- Get an NUS MSc degree (coursework) 得到NUS 授课型硕士学位

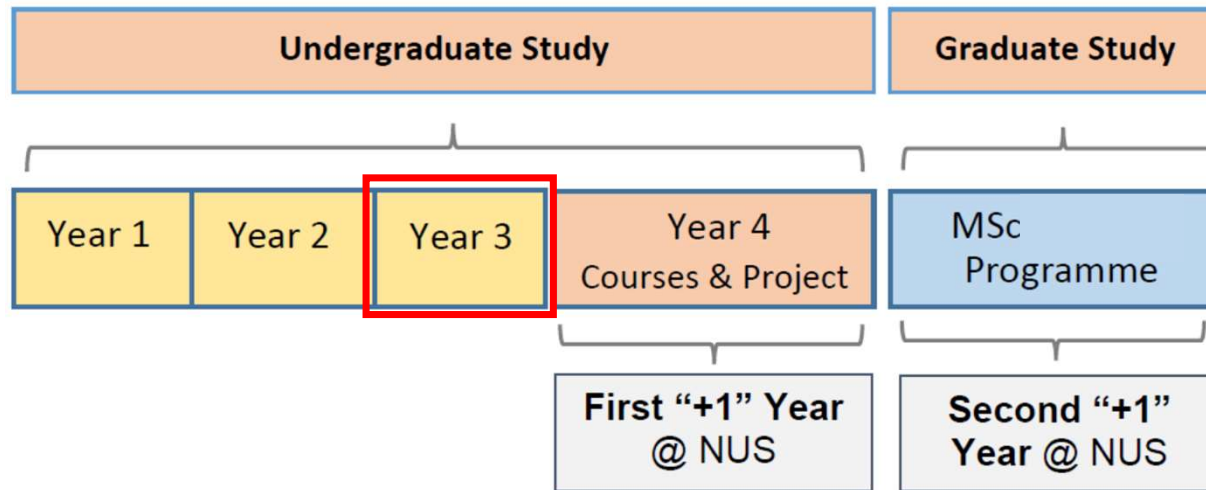

Year 3 candidates from Partner University 合作院校第三年本科生

- Good academic standing 良好的学术背景
- Meet NUS English requirement (IELTS ≥ 6.0 or TOEFL ≥ 85) 达到NUS录取英语要求
- Pass interview by NUS panel 通过NUS委员会的面试

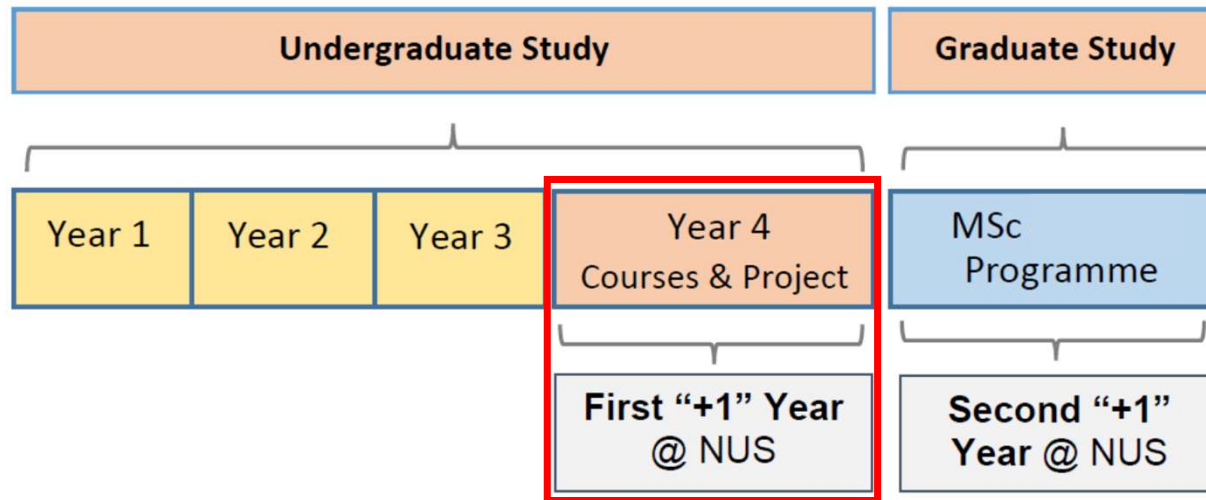

First +1 year at NUS

- At least 16 units of graduate courses.
 - A typical course spanning one semester carries 4 units.
- Takes a Final Year Project (FYP).
 - If FYP is not required by Partner University, it can be replaced with 8 units of courses.
- Courses & FYP to fulfil the graduation requirements of Partner University
- **No Joint Degree** 无双学位

至少完成16学分研究生课程
一门正常研究生课程是4学分

参与毕业设计
如果毕业设计并不是合作院校的必须要求，
可替换为8个学分的课程

课程和毕业设计需要满足合作院校的毕业要求

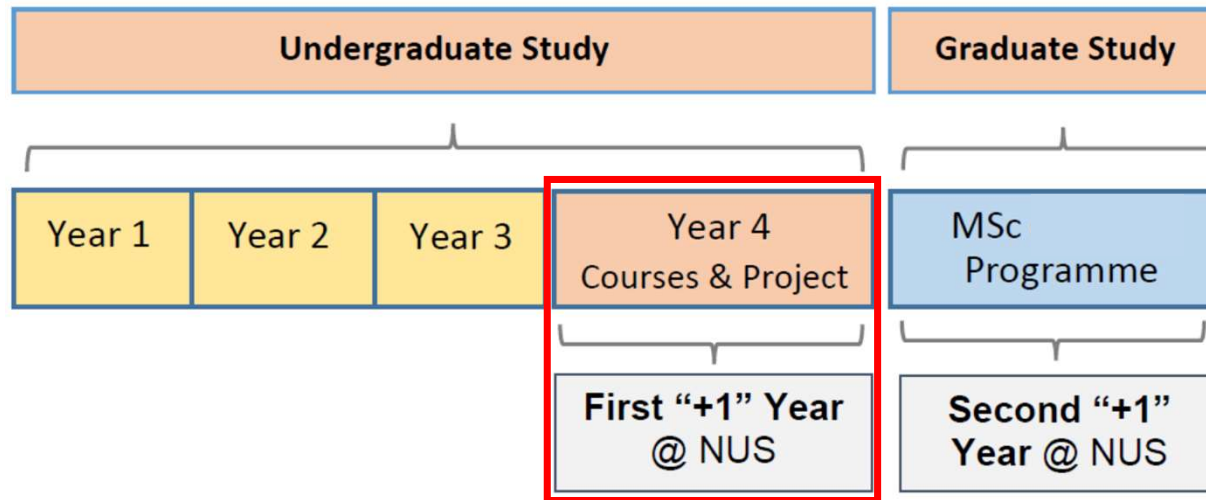

First +1 year at NUS

- Apply for admission to MSc in Dec (Semester I)
- Provisional admission, pending
 - Graduation from Partner University with good standing
 - Complete Final Year Project
 - Completion of at least 16 units of courses in NUS with a minimum GPA of 3.50/5.00

第一学期结束（12月）申请MSc

NUS录取需要满足以下条件：

- 满足合作院校毕业要求
- 完成毕业设计
- 至少完成16个学分的课程并取得3.5以上的绩点

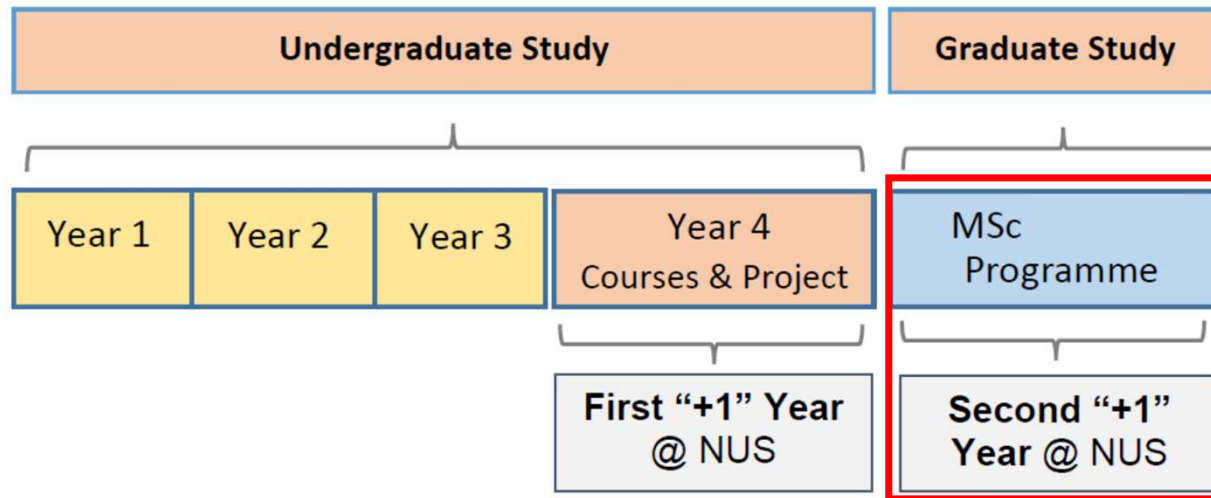

Second +1 year at NUS (MSc coursework)

- Standard graduation requirements: 40 units of courses
- 311 program: Transfer up to 10 units of courses to MSc
- Complete remaining units of courses to graduate with a NUS MSc degree

MSc 毕业要求:

- 完成40个学分
- 311项目: 可以转入10个学分进入MSc阶段
- 完成剩下的30学分即可获得NUS MSc学位

Benefits

- Working towards a NUS MSc degree starting from first +1 year
- MSc program fee rebate (see later slides)

项目优势:

- 第一年(大四)即可参与MSc课程学习
- NUS学费政策



NUS curriculum and details

MSc(CE)

- <https://cde.nus.edu.sg/cee/graduate/coursework-based-programmes/msc-ce/>

Fees (first +1 year)

Item	Fees (S\$)	Comments
Courses (16 units)	21,241.48	<ul style="list-style-type: none">• 4 courses of 4 units each• S\$5,310.37 per course
Final Year Project (Research fees)	2,600.00	<ul style="list-style-type: none">• S\$1,300.00 per semester• 2 semesters of FYP
Miscellaneous fees	327.00	
Total	24,168.48	

Correct as of Dec 2023. Please refer to the NUS CEE website for the most updated fee.

Fees (second +1 year)

Item	Fees (S\$)	Comments
MSc (Civil) Program Fee	53,103.71	<ul style="list-style-type: none">• Full program fee based on 40 units

Correct as of Dec 2023. Please refer to the NUS CEE website for the most updated fee.

Fees (second +1 year)

Item	Fees (S\$)	Comments
MSc (Civil) Program Fee	53,103.71	<ul style="list-style-type: none"> Full program fee based on 40 units

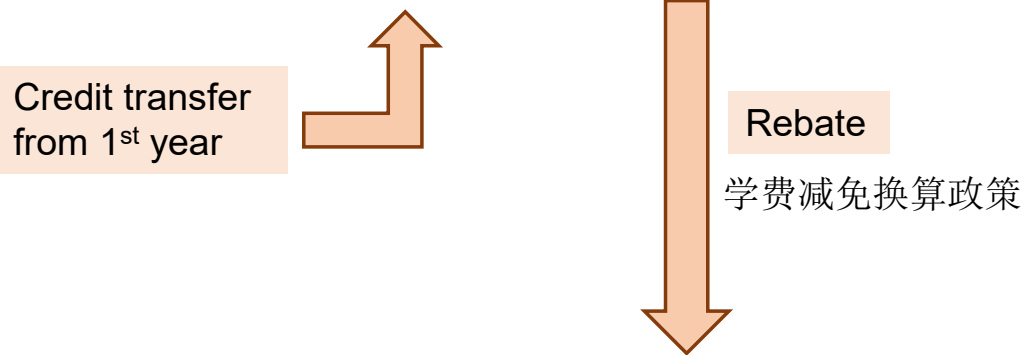

Item	Fees (S\$)	Comments
MSc (Civil) Program Fee	39,827.78	<ul style="list-style-type: none"> Assume 10 units credit transfer

Expenses

Accommodation + Food + Transportation

- S\$1,600 – S\$2,500 per month

新加坡留学生一个月多少钱

2022-09-20 16:13:54 来源：中国教育在线

去往新加坡留学的学生注意了，除了要准备留学的学费之外，同学们还要了解一下当地的生活消费水平，下面小编就给大家分析一下新加坡留学生一个月多少钱，以便后期准备好资金！



新加坡留学生一个月生活费

新加坡留学生生活费一个月需要1600-2500元新币左右，生活费包括住宿费、饮食费、交通费、通讯费等，其中住宿费每月需要500-1500新币，住宿费因地段、环境、配套设施、居住人数等因素而定。



Halloween Outing Along Sentosa Boardwalk
(2022 Oct)



Universal Studios Singapore
Halloween Horror Night (2022 Oct)



Outdoor Escape Race (2023 Nov)

Activities



Guided Bike Tour
(2023 Mar)



Mystery Relay
Race @ NUS
(2023 Oct)

Typical Timeline

申请时间线

Jan - Feb	• Year 3 students to apply to home university coordinator for 311 program
Mar	• NUS-CEE process application results and inform partner university
21 Mar – 10 Apr	• Online application in NUS portal by selected students
May - Jun	• Students receive official NUS offer, onboarding processes

国内院校校内申请311

NUS通知录取结果

NUS网上申请

学生取得正式录取

Get the following documents ready for submission (by end Feb)

所需材料

- Valid passport (minimum validity until end of May 2025) 护照
- English test results (IELTS \geq 6.0 or TOEFL \geq 85), test taken after 21 Mar 2022 only
(results have 2-years validity period) 英语成绩证明
- Latest transcript (typically 5th semester/mid of 3rd year), English version 最新成绩单英文版 (5学期)



MSc (Civil) Program

- Many established professional engineers as co-lecturers, together with award winning NUS professors

知名的专业工程师与新加坡国立大学教授共同授课

- Rigorous training and hands-on experience to establish connections between theory and practice

严格的训练和实践经验，建立理论与实践之间的联系

Customise your MSc degree

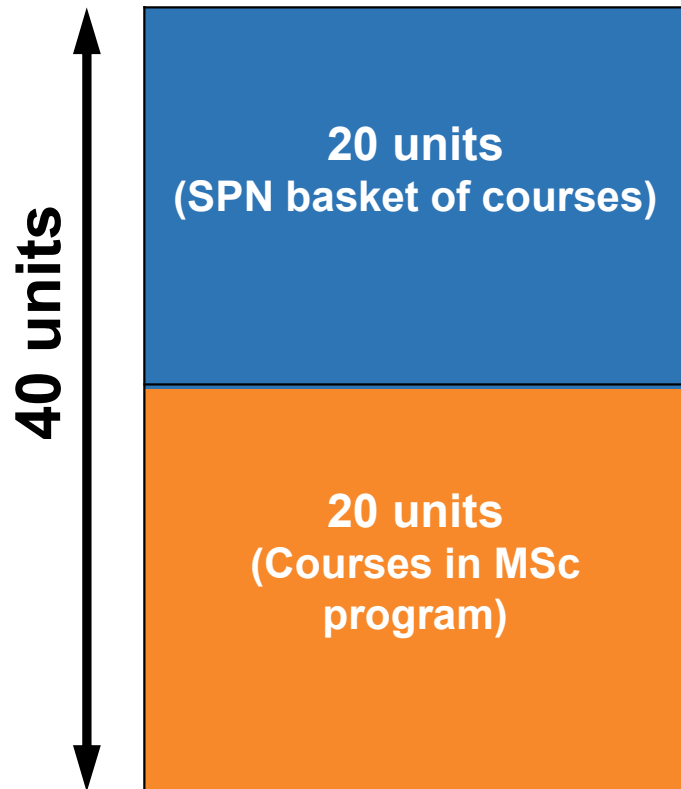

- Complete a total of 40 units
总共完成40学分课程
- Customization based on personal interests and professional needs
根据个人兴趣及专业需求个性化定制
- Graduate with a MSc(CE) degree with specialization
获取授课型硕士专业学位

Customise your MSc degree

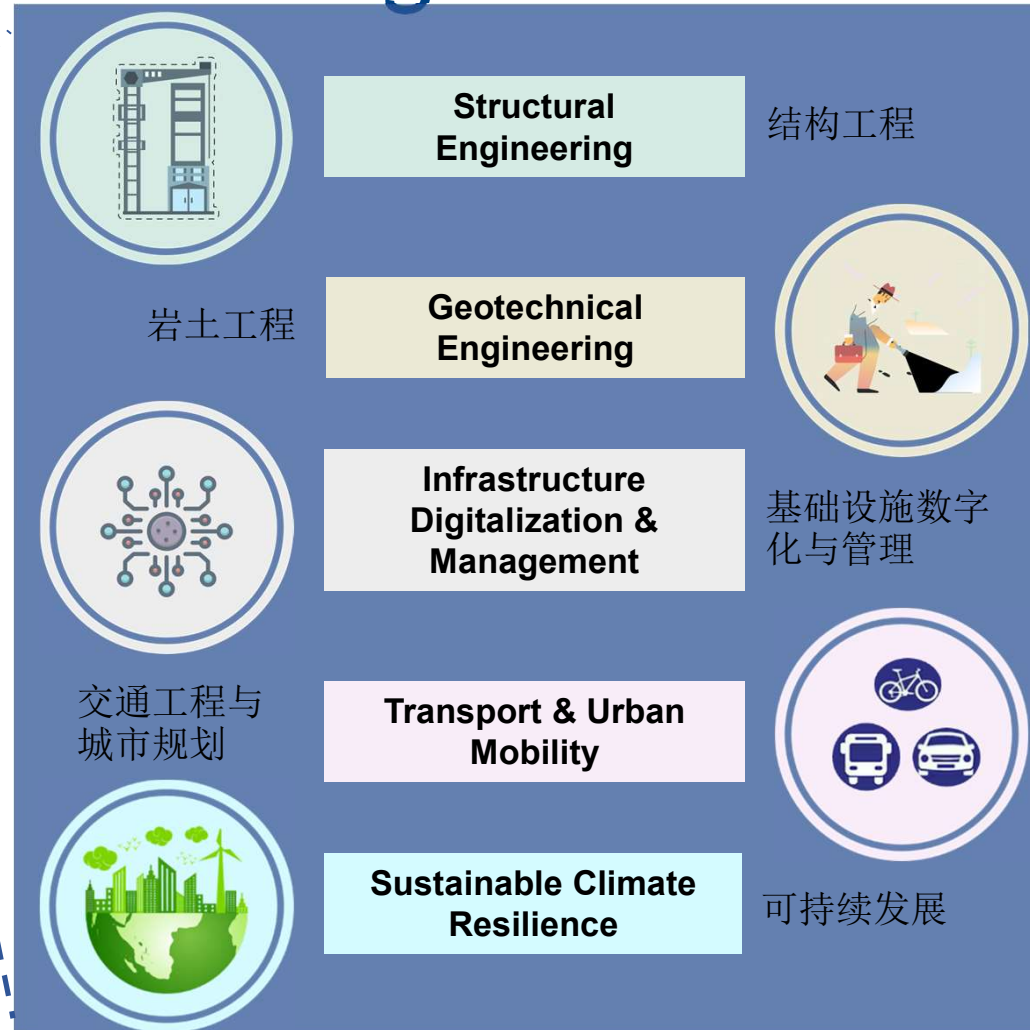
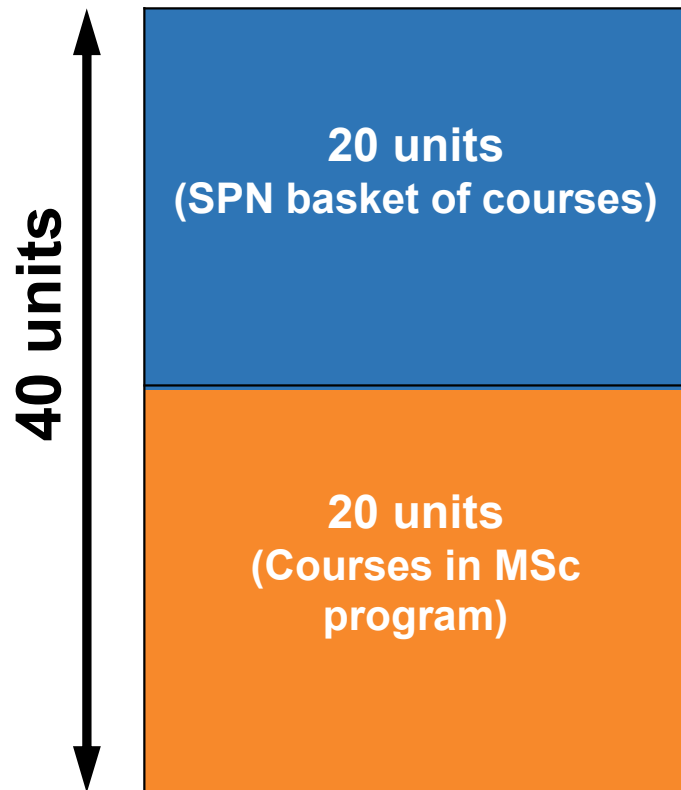

Global recognition of NUS degrees by employers

调查显示，雇主们倾向于寻找具有领导能力以及能够展现社会影响力的大学毕业生。团队协作能力与合作精神，也同样受到各国雇主的重视。

《泰晤士报高等教育特辑》（Times Higher Education）
2023年全球大学就业力排名



2023	2022	大学
1	2	加州理工学院
2	1	麻省理工学院
3	5	斯坦福大学
4	4	剑桥大学
5	3	哈佛大学
6	9	普林斯顿大学
7	7	东京大学
8	6	牛津大学
9	8	新加坡国立大学
10	10	耶鲁大学
35	32	南洋理工大学

资料来源：全球大学就业力排名



<https://www.zaobao.com.sg/news/singapore/story20231124-1451978>

Practical Training via Capstone Project 实践培训项目

- Integration of concepts learnt in specialization courses 整合专业课程中所学的概念
- Guidance from established industry practitioners 来自行业从业者的指导

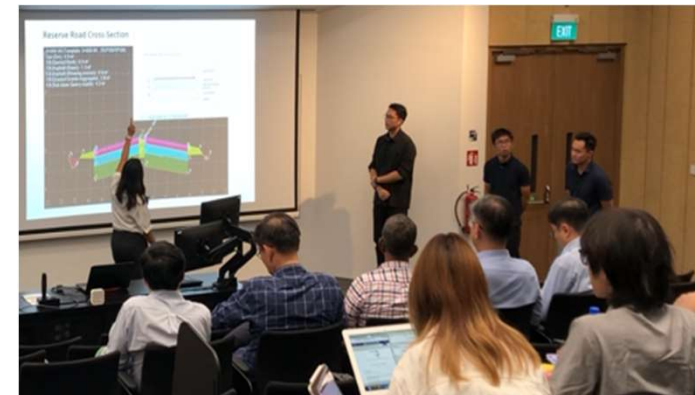
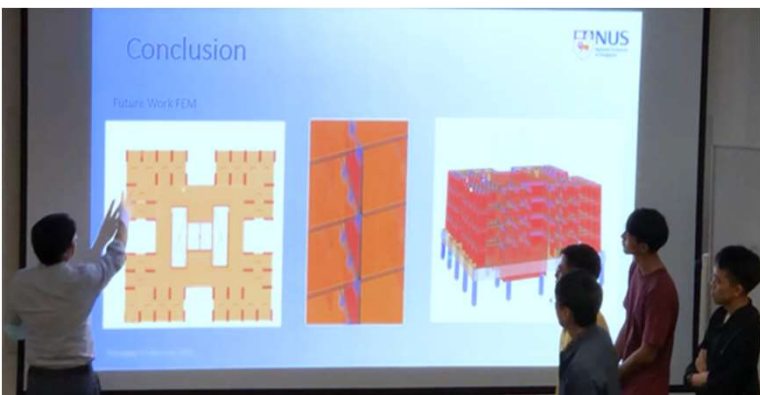
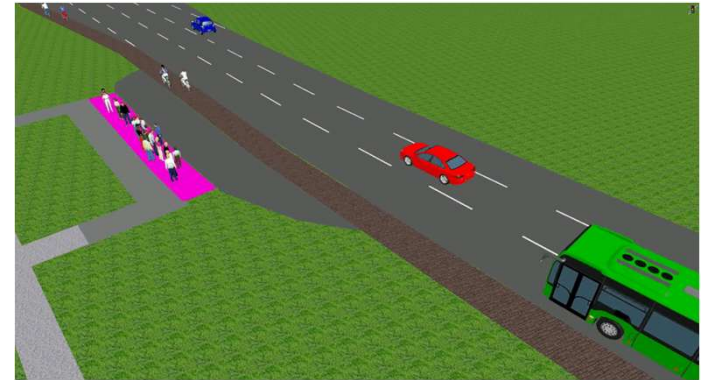

Capstone Projects

STRUCTURAL ENGINEERING

Design a PPVC point block building with
3-storey underground basement

SKILLS DEVELOPMENT

- Structural Materials
- Advanced Structural Design and Analysis
- Contemporary Construction Methods

GEOTECHNICAL ENGINEERING

SKILLS DEVELOPMENT

- Site Investigation
- Ground Improvement
- Foundation Design
- Deep Excavation

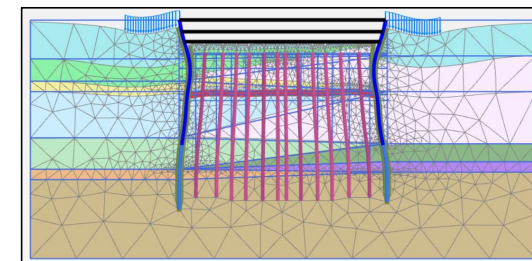
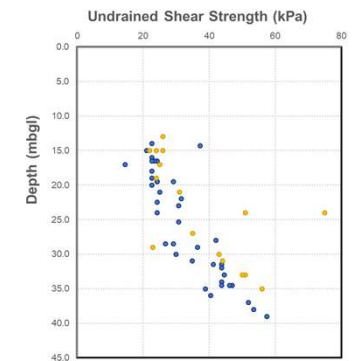
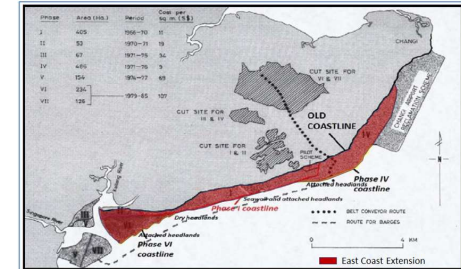

Capstone Projects

INFRASTRUCTURAL DIGITALIZATION & MANAGEMENT

Design and manage the construction of a nursing village using Integrated Digital Delivery

SKILLS DEVELOPMENT

- Data Analytics
- Building Information Modelling
- Digital Twins
- Construction Automation & Technology

TRANSPORT & URBAN MOBILITY

Design transportation infrastructure and mobility solutions in a new town

SKILLS DEVELOPMENT

- Transportation Planning
- Traffic Engineering
- Transport Modelling
- Data Analytics

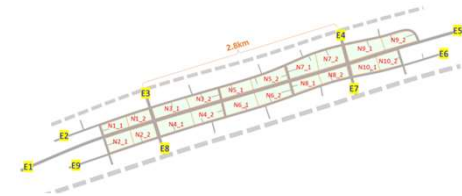
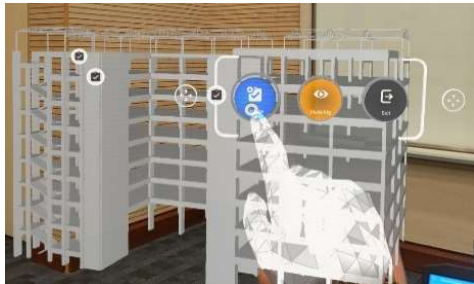
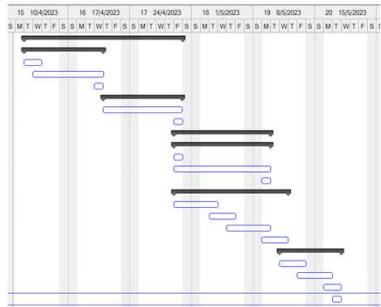

Structural Engineering

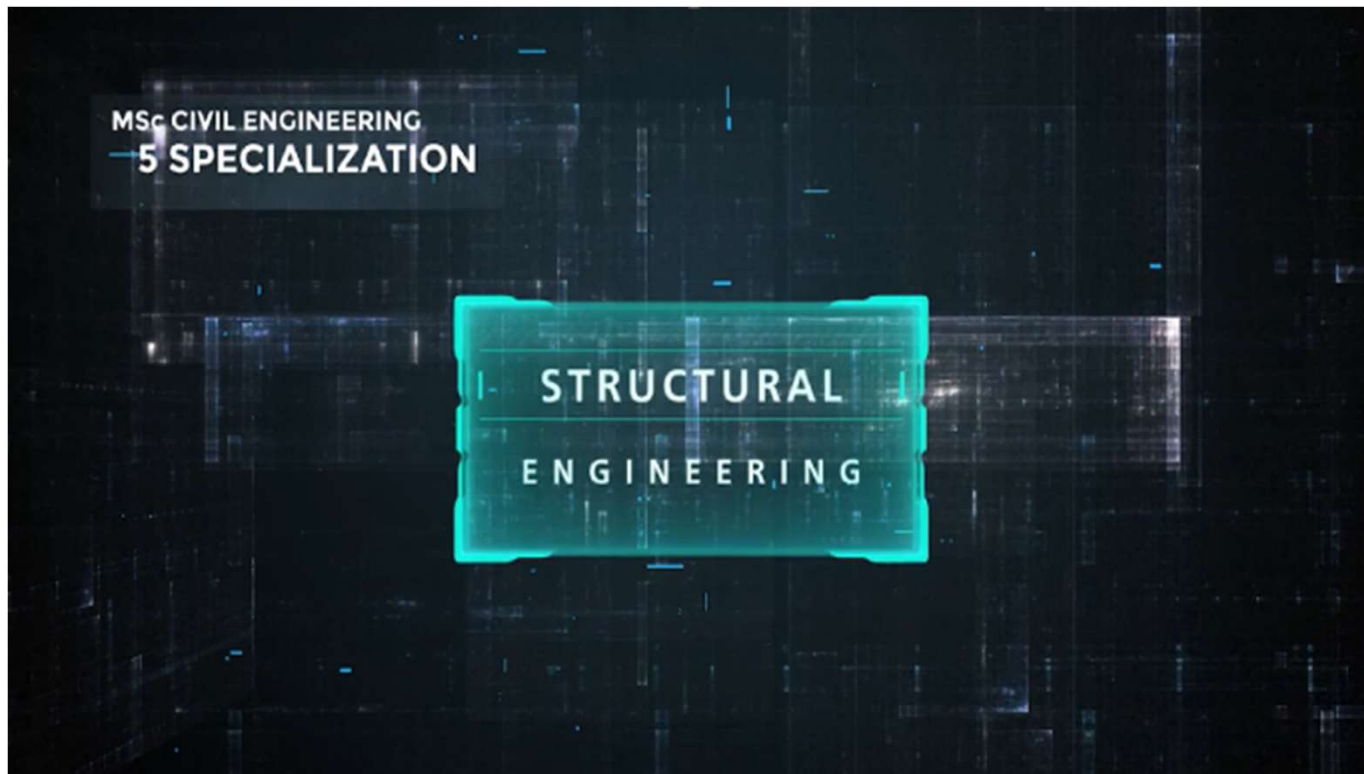

Geotechnical Engineering



Infrastructure Digitalization & Management



Transport & Urban Mobility

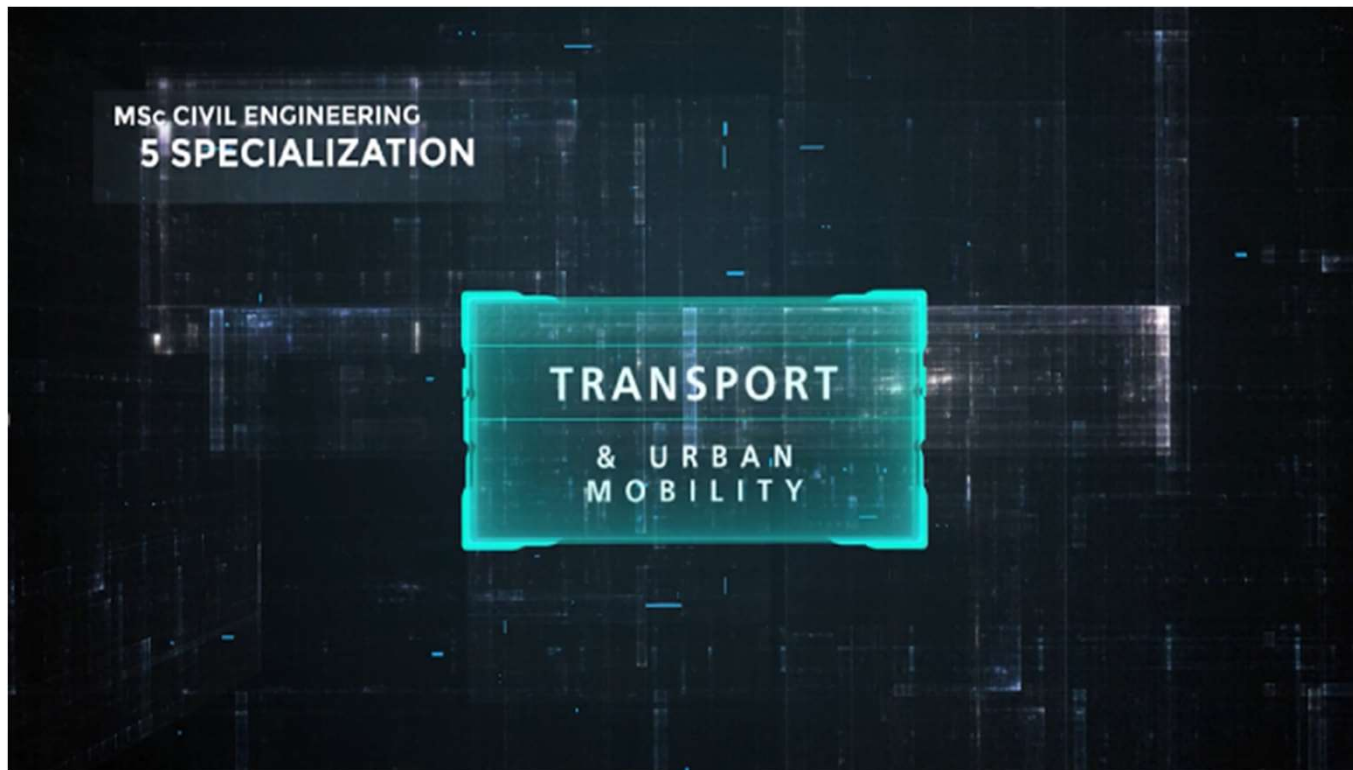

Sustainable Climate Resilience



**NUS Master of Science
Civil Engineering**
Specialization in Sustainable Climate Resilience



Industrial Internship (NEW) 工业实习

- Real-world training 实践训练
- Full time internship with leading companies in Singapore 在新加坡知名企业全职实习
- 1 Semester (16 weeks) 一学期
- Starting Jan 2024



Student Exchange (NEW) 国际交换项目

- Broaden your outlook and foster a global mindset 拓宽国际视野
- 1 Semester MSc Student Exchange Program 1学期授课硕士交换计划
- Starting Aug 2024



- Pending:
 - University in Switzerland
 - University in Australia





Questions?



Thank you

MSc(CE) Pathway 1

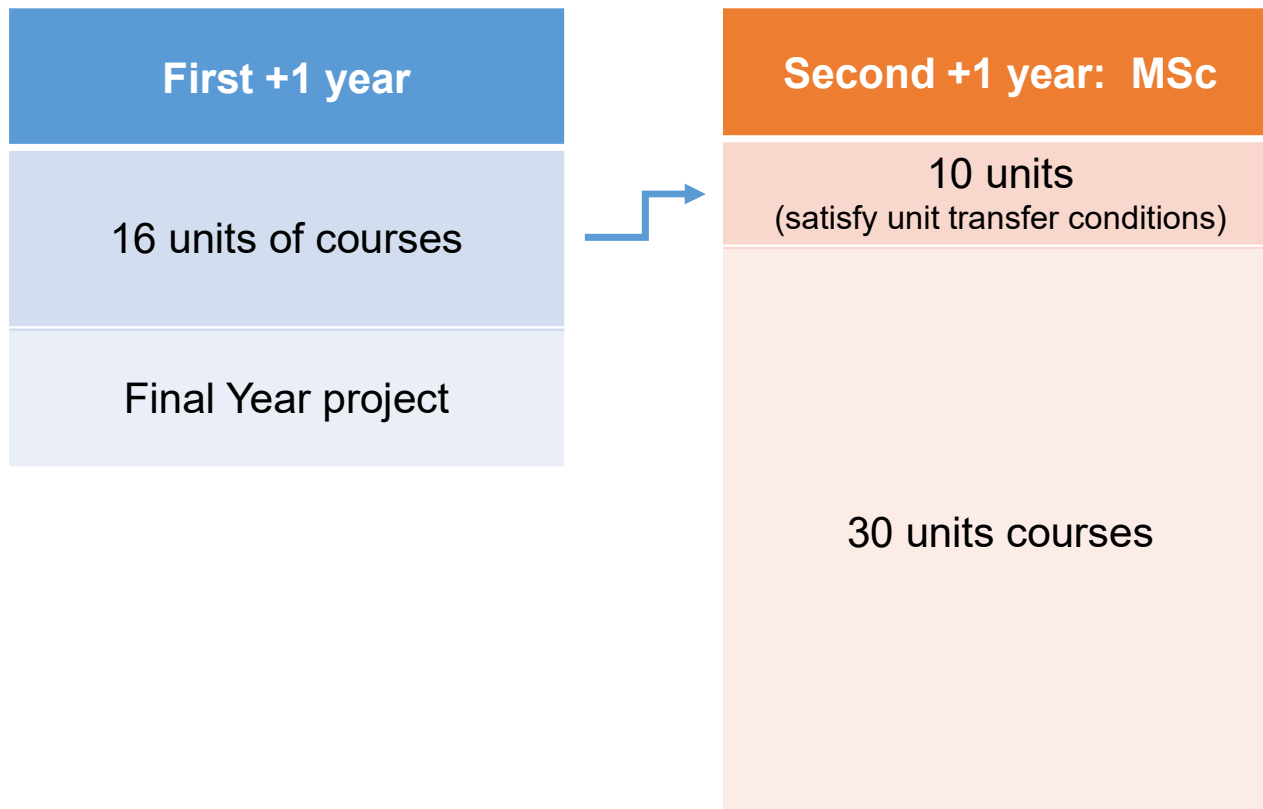

MSc(CE) Pathway 2 (Research)

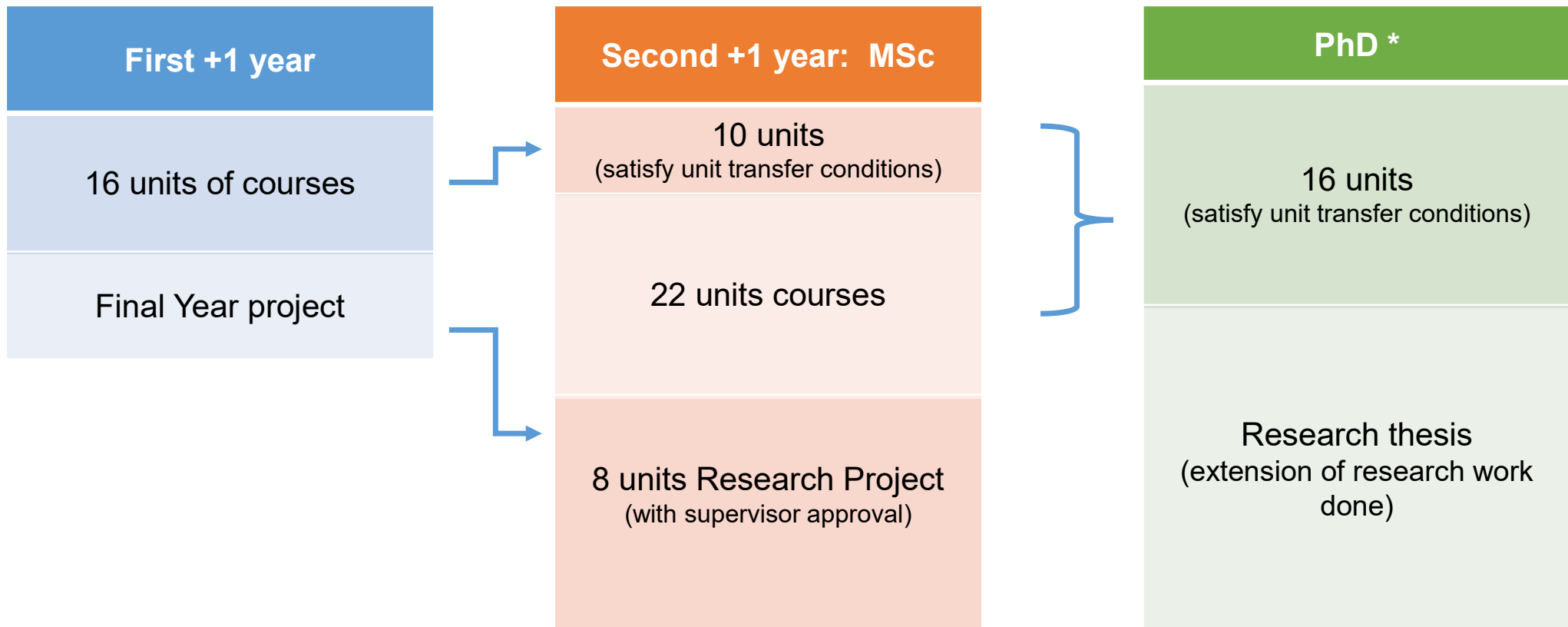

* Standard admission criteria